

# Návod k instalaci Belver black

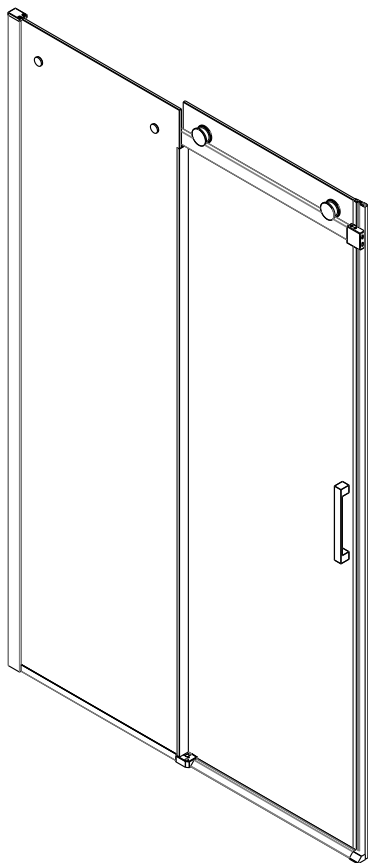



## GENERAL INFORMATION

Please inspect the product immediately upon receipt for transit damage, missing packs/parts or manufacturing fault. Damage reported later cannot be accepted. Please handle the product with care avoiding knocks and shock loading to all sides and edges of the glass.

## NOTES: Safety glass can not be re-worked

Please read these instructions carefully before start of installation.

Special care should be taken when drilling walls to avoid hidden pipes or electrical cables.

Note: This product is heavy and may require two people to install.

## AFTERCARE INSTRUCTIONS

After use, your shower should be cleaned with soap and water. This is particularly important in hard water districts where insoluble lime salts may be deposited and allowed to build up. Cleaners of a gritty or abrasive nature should not be used. Care should be taken to avoid contact with strong chemicals such as organic solvents and strippers.

Class cleaners can be used but with caution, if in doubt contact the manufacturer of the cleaner in question.

Please keep these instructions for aftercare and customer service details.

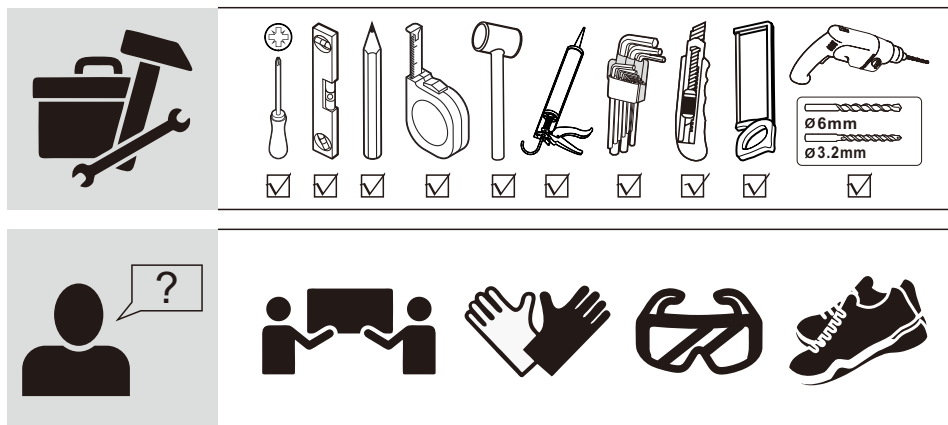

## Box -1

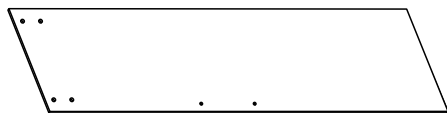

[01] x1



[02] x1

## Box -2

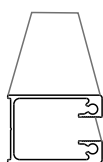

[03] x1



[04] x1



[05] x1

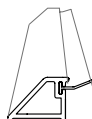

[06] x1



[07] x1



[08] x1



[09] x1



[10] x1



[11] x1



[12] x1



[13] x1



[14] x2



[15] x2



[16] x2



[17A] x1

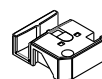

[17B] x1



[18] x1



[19] x1



[20] x4



[21] x4



[22A] x1



[22B] x1



[23] x11

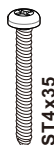

[24] x9

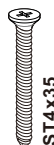

[25] x2



[26] x2



[27] x1



[28] x1



[29] x1

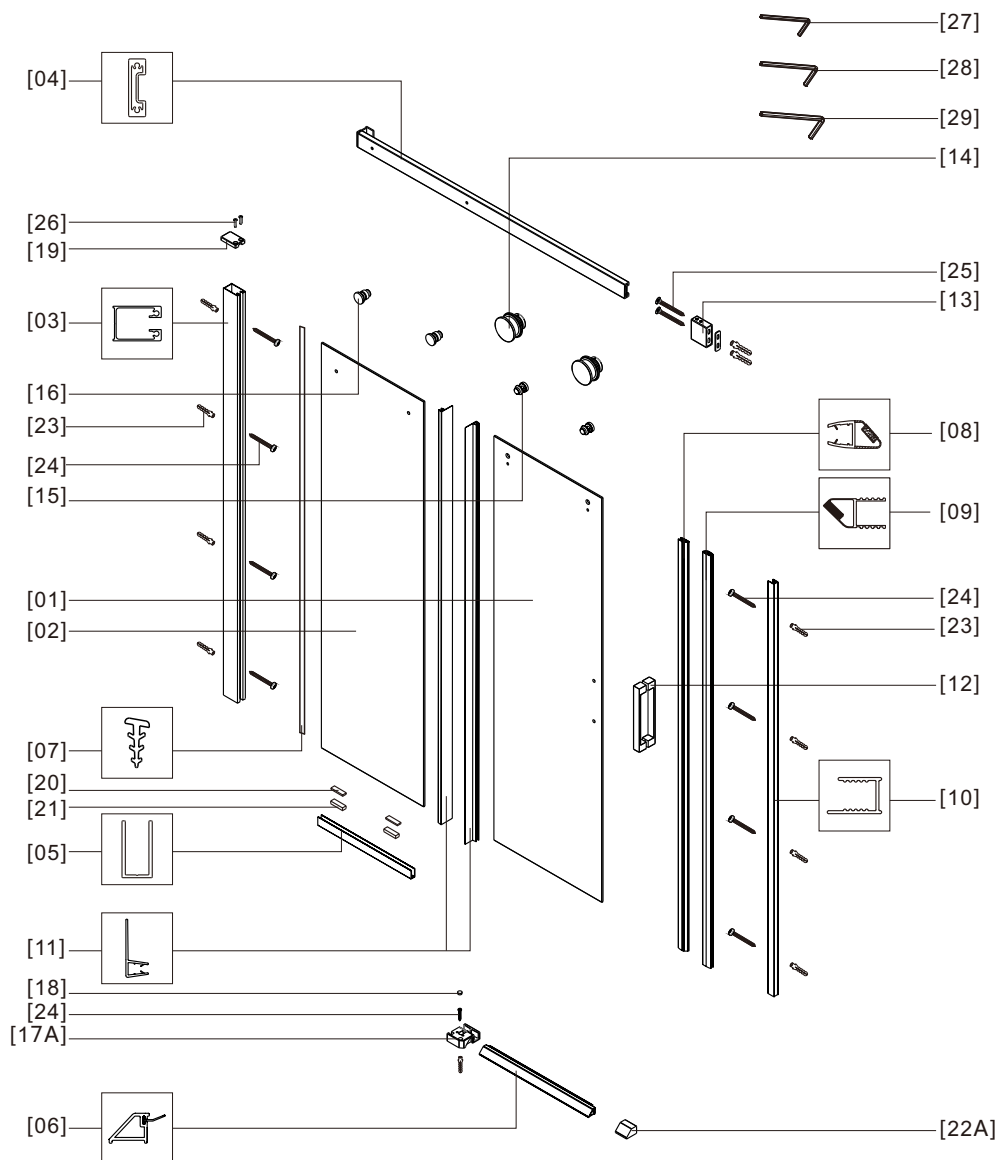

# 01

Size ( mm )	L1	
	Min.	Max.
1000	970	1000
1100	1070	1100
1200	1170	1200
1400	1370	1400
1500	1470	1500

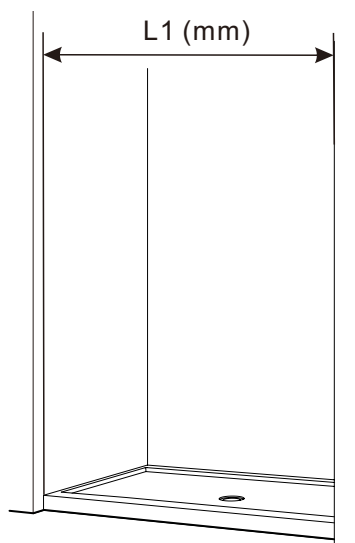

# 02

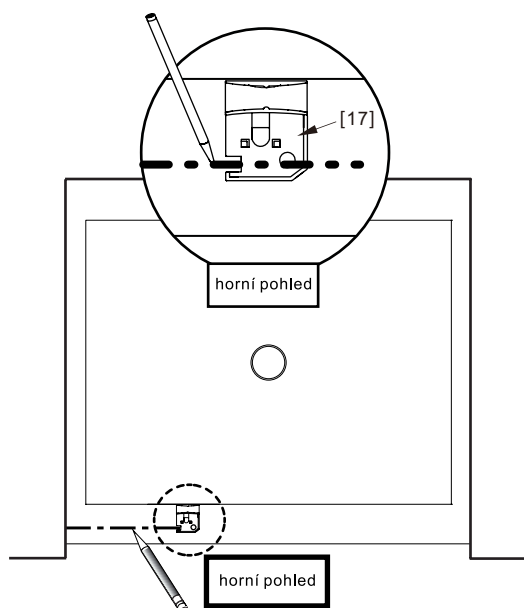
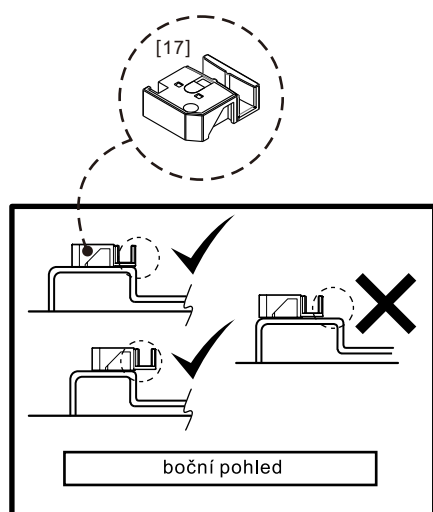

**03**

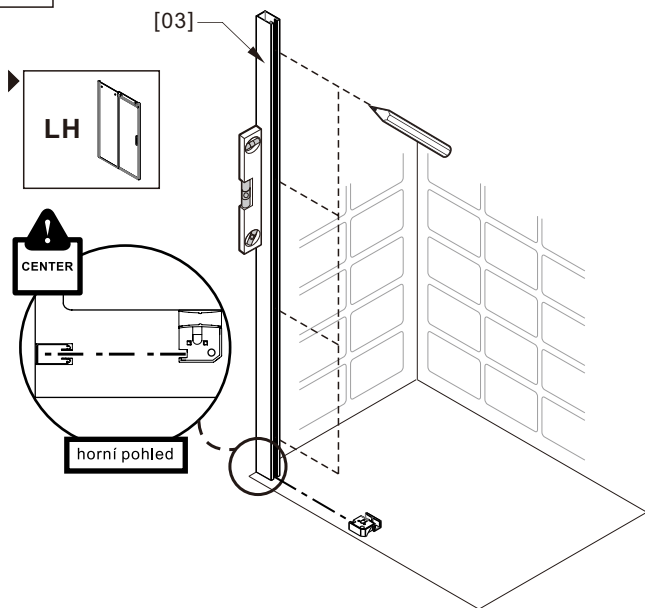

**4x**

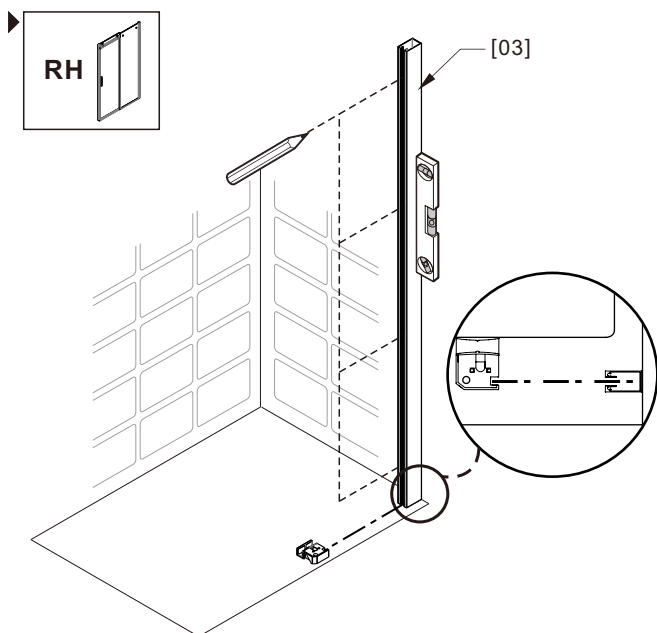
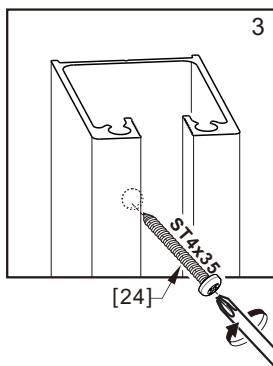
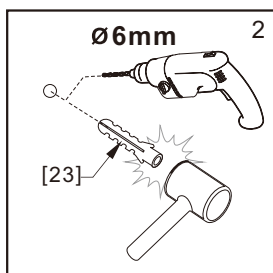
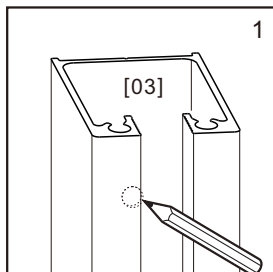

# 04

Ujistěte se že U profil je v rovině.

Délka profilu 100 cm

Potřebná délka	970	975	980	985	990	995	1000
Nutno uříznout z U profilu	25	20	15	10	5	0	0

**U profil lze upravit až o 25 mm. Když je sklo úplně vloženo do svislého profilu, spodní U kanál musí být řez 25 mm, když sklo není zcela zasunuto do pevného profilu na zdi, je třeba spodní U profil zkrátit.**

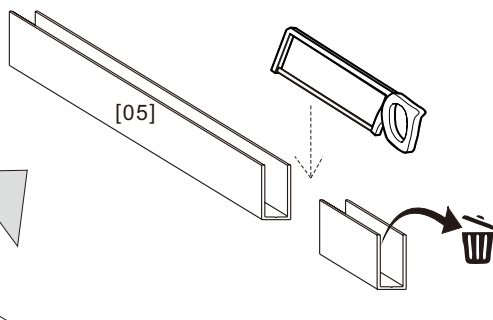
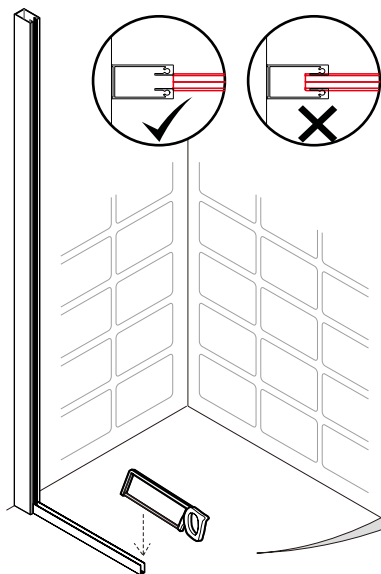

# 05

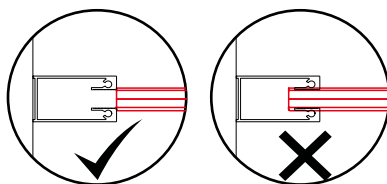
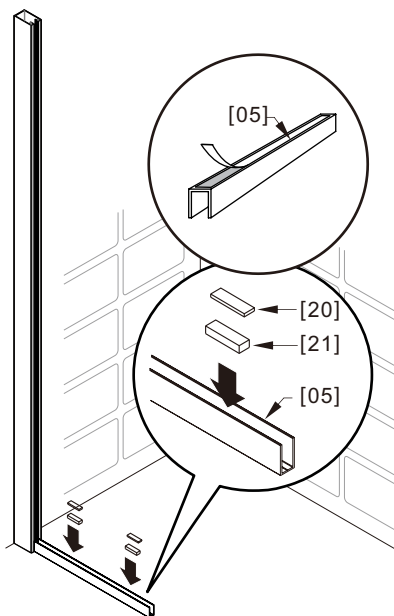

Ujistěte se že U profil je v rovině.

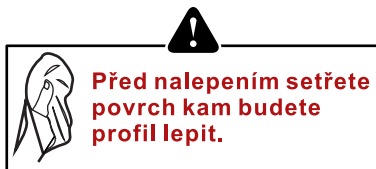

**Před nalepením setřete povrch kam budete profil lepit.**

06

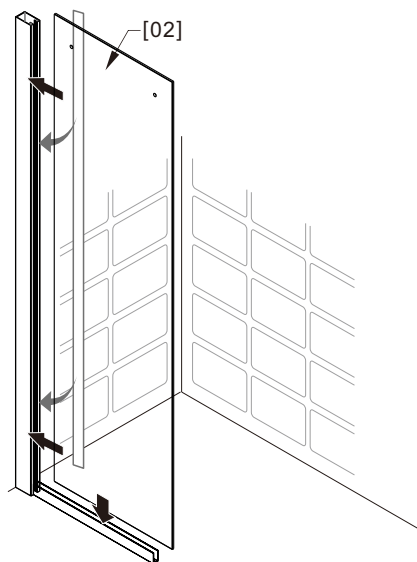
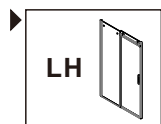

2x

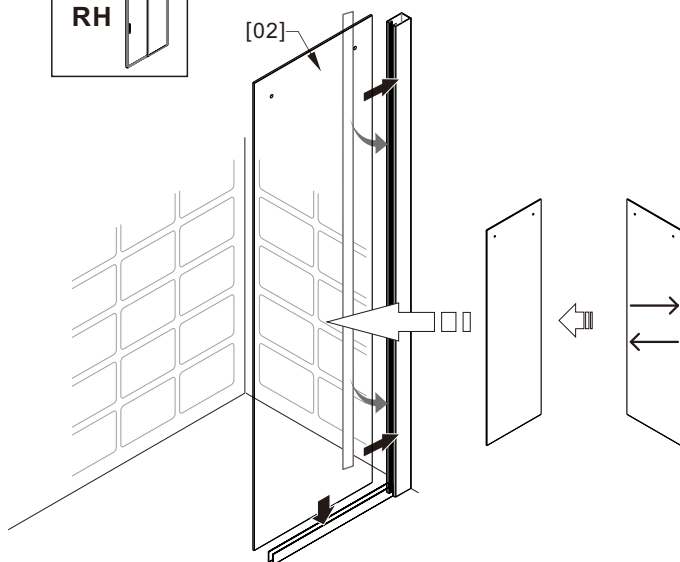
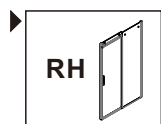
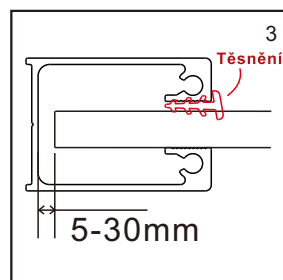
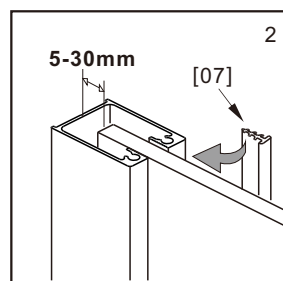
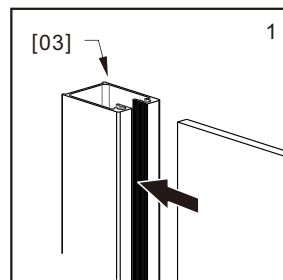



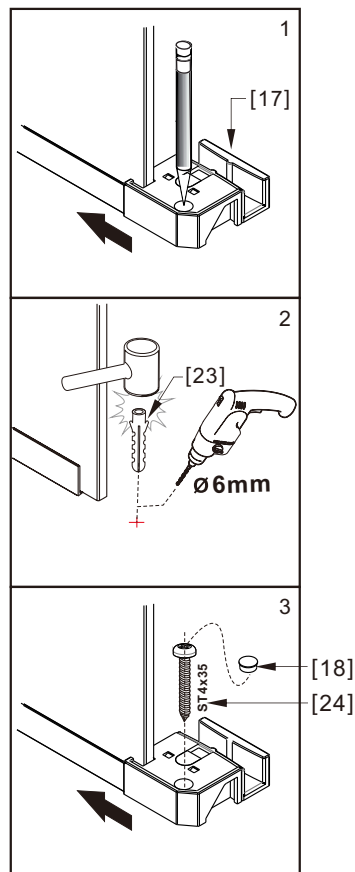
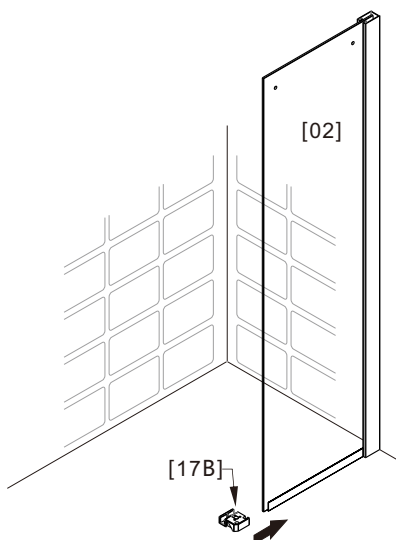
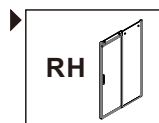
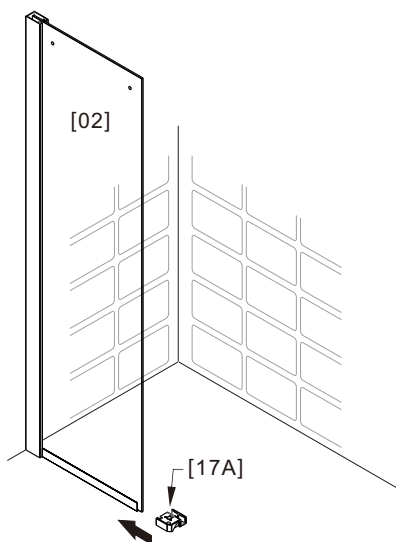
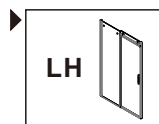

**08**

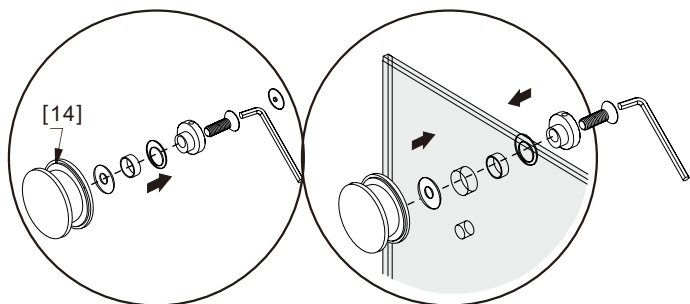
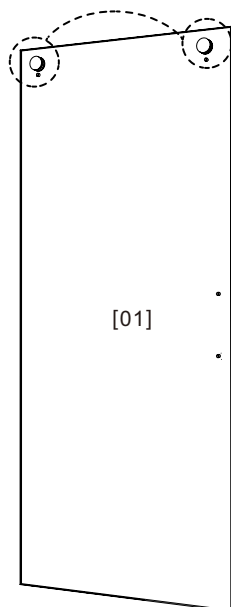

**09**

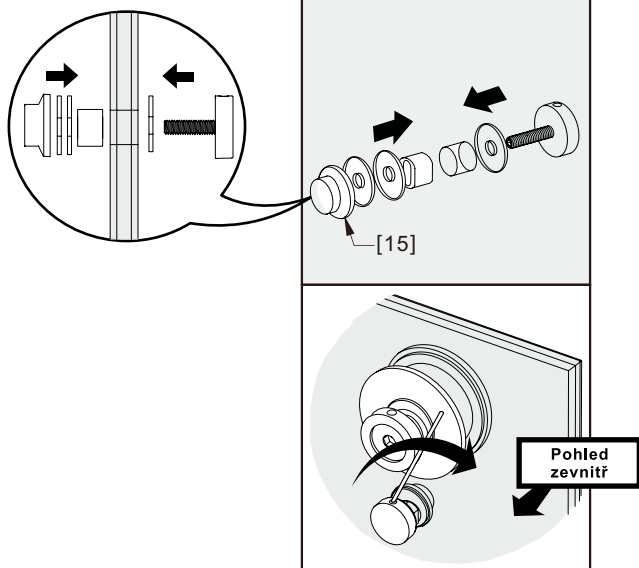
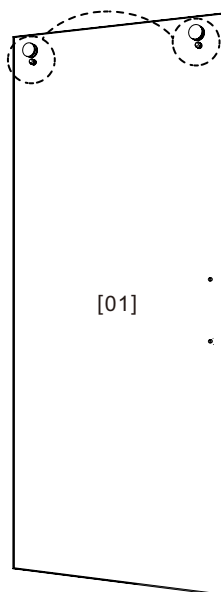

10

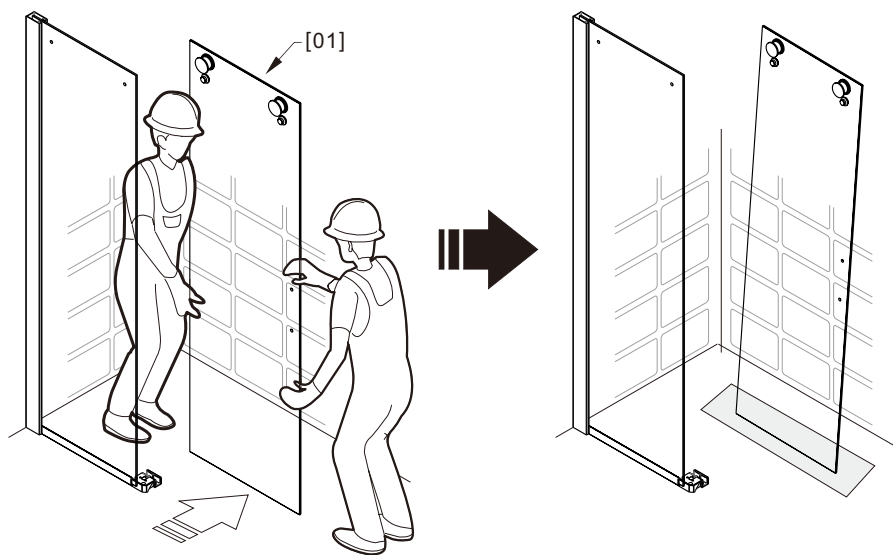

11

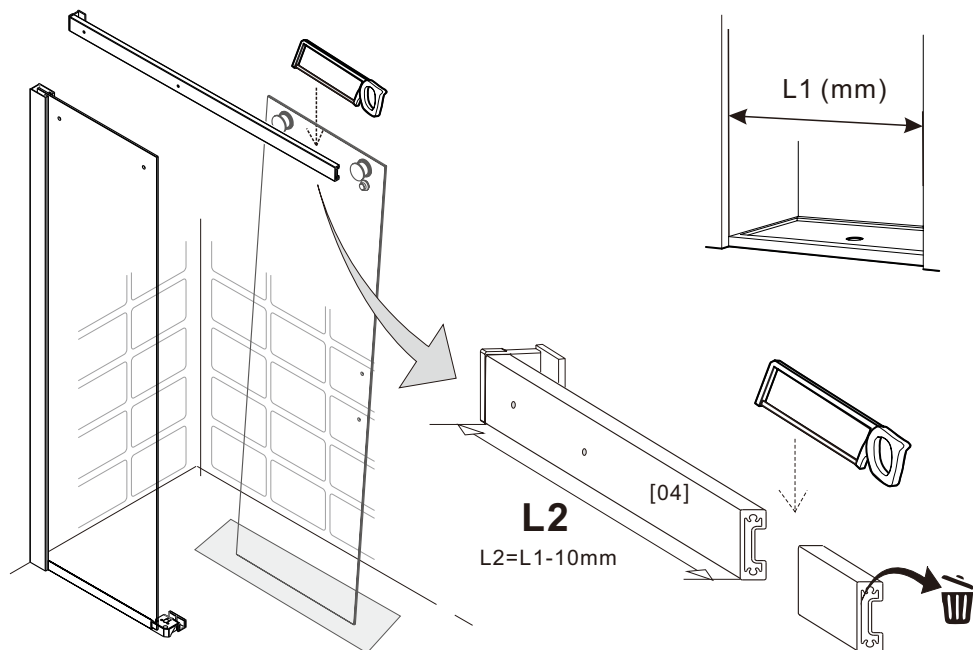

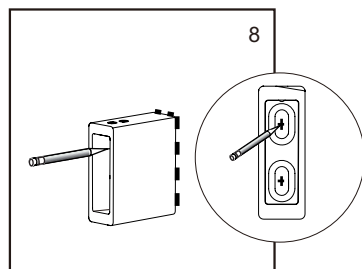
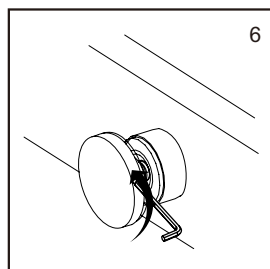
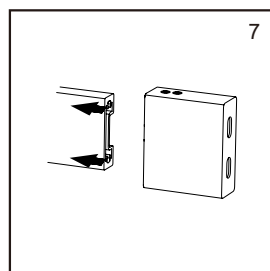
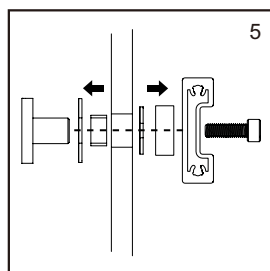
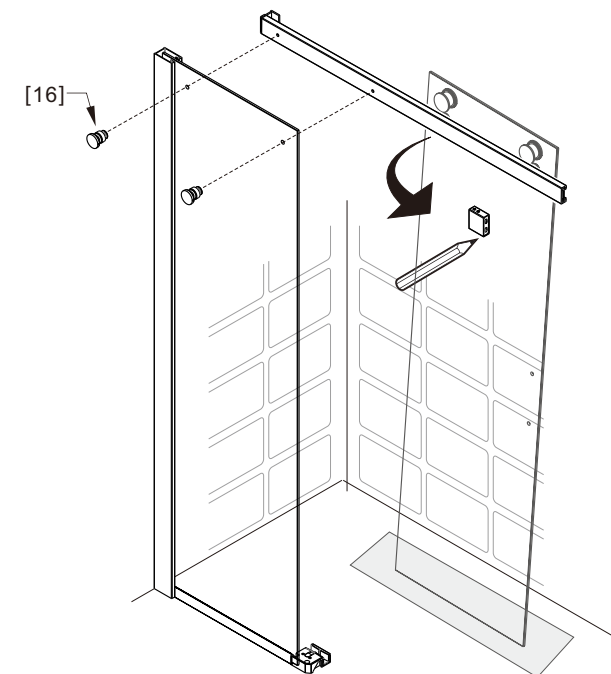
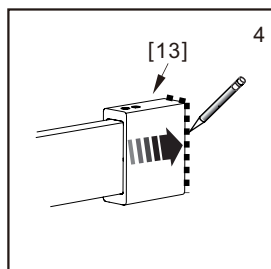
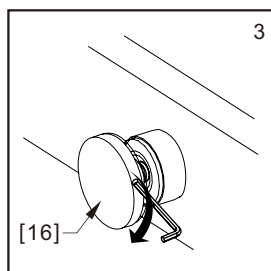
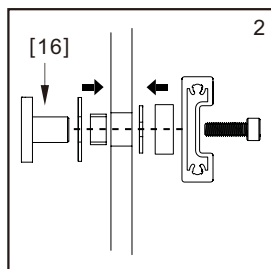
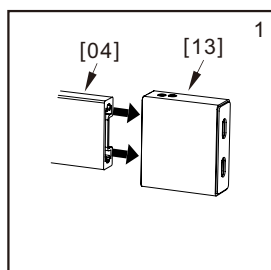

13

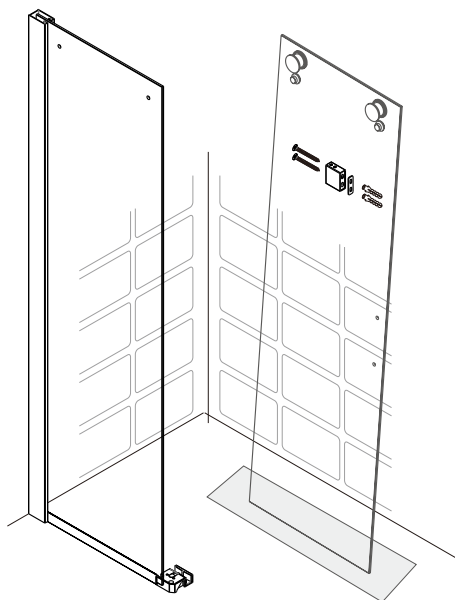
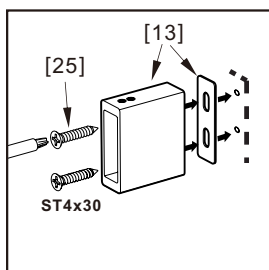
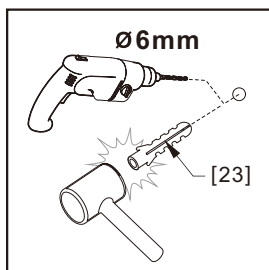

14

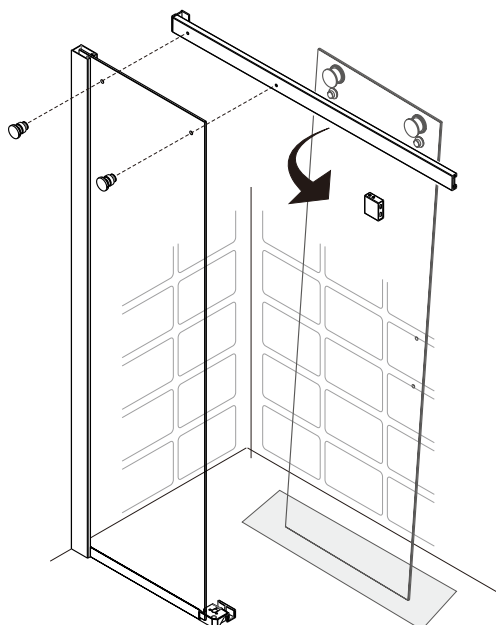
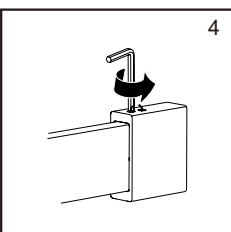
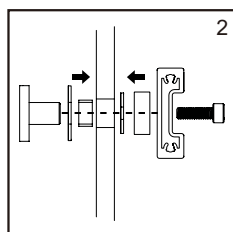
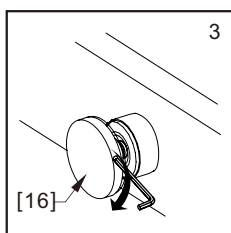
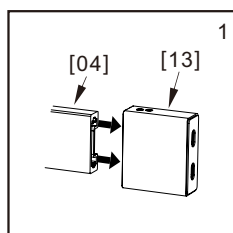

15

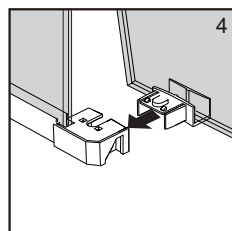
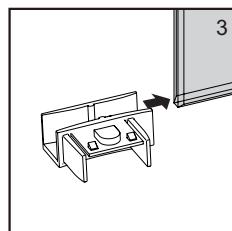
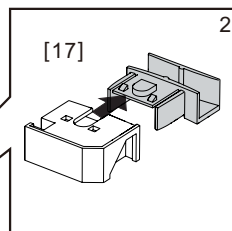
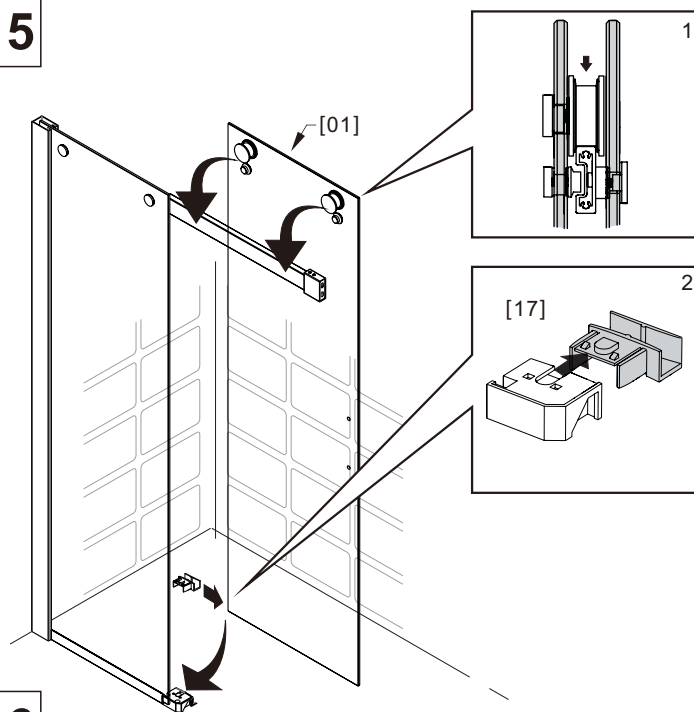

16

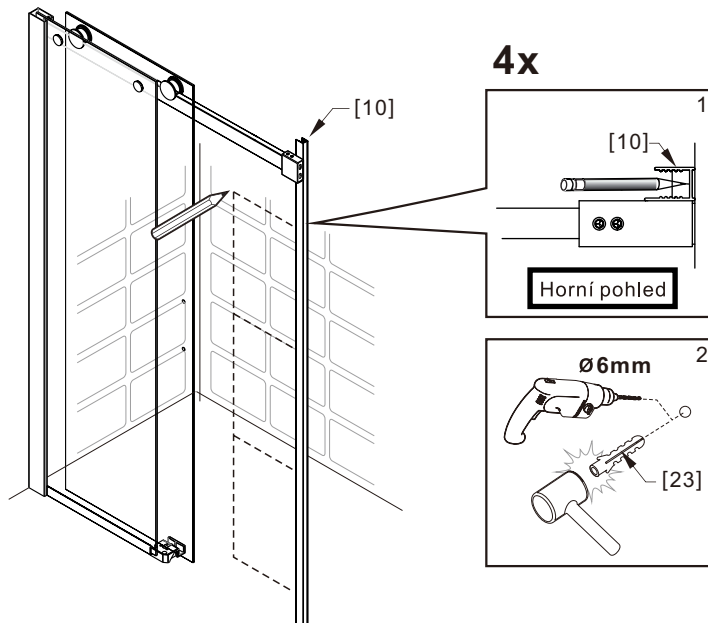

4x

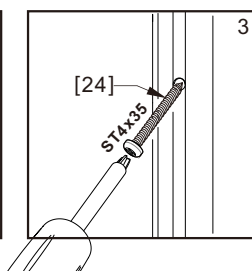
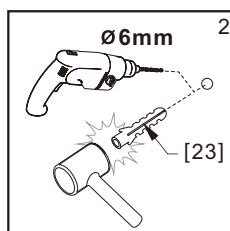

17

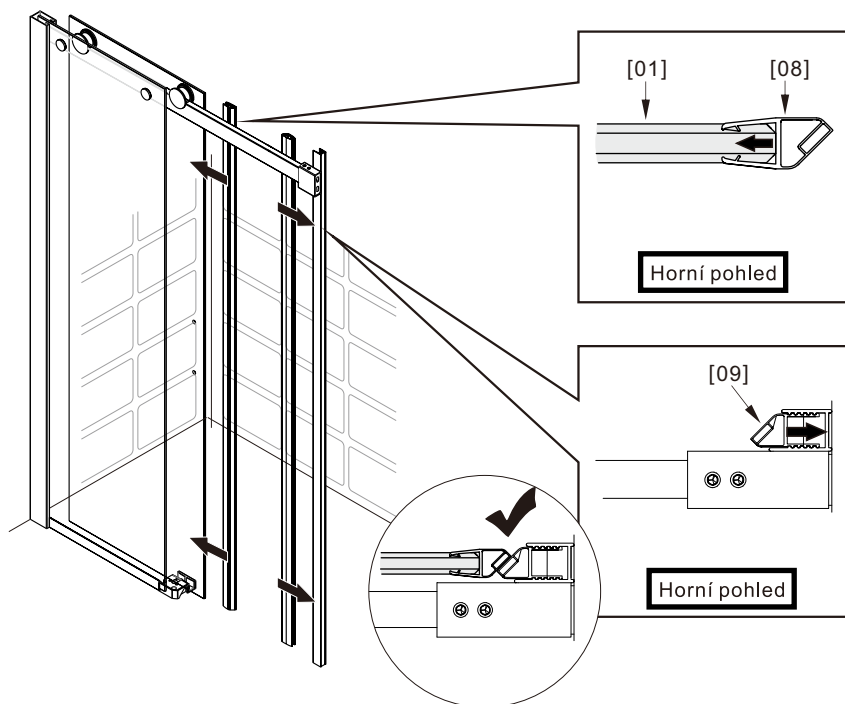

18

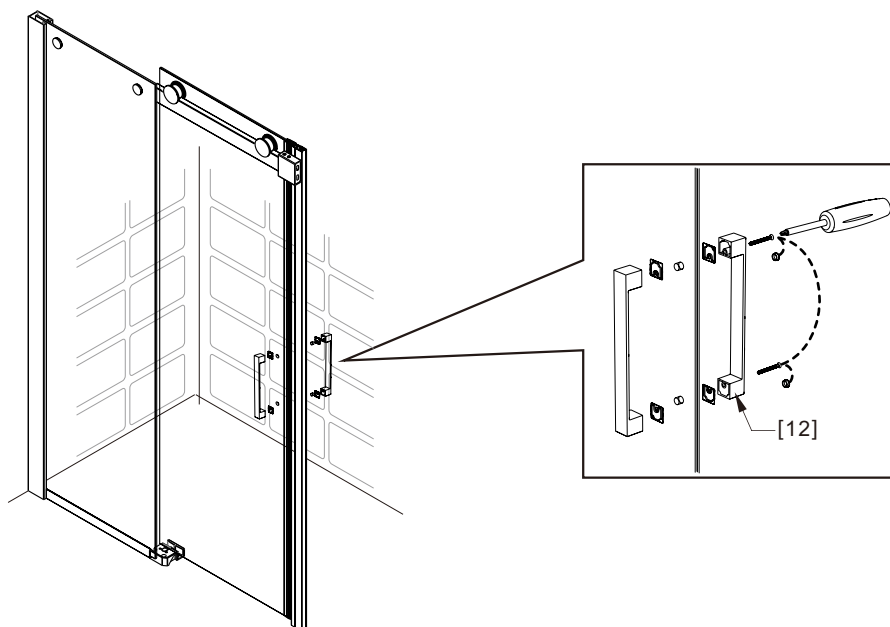

19

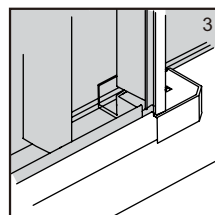
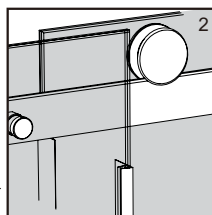
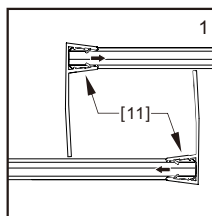
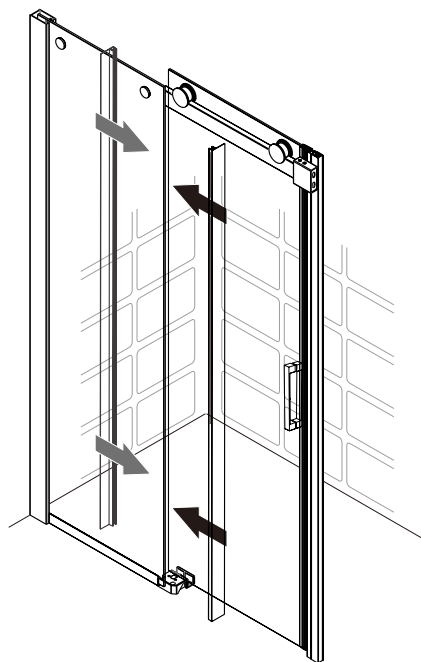

20

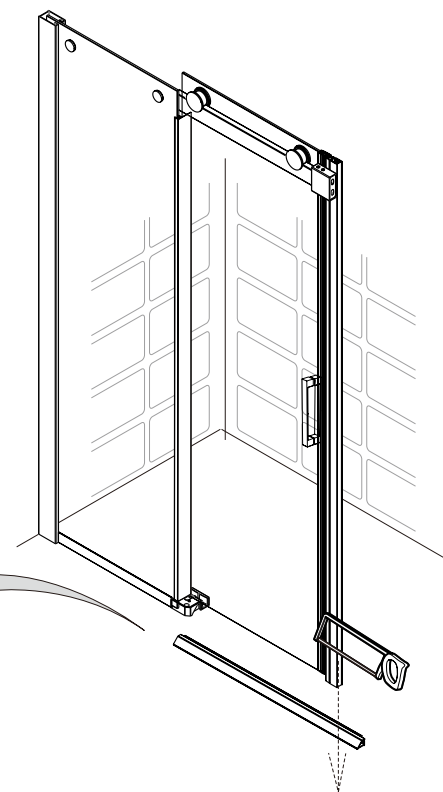
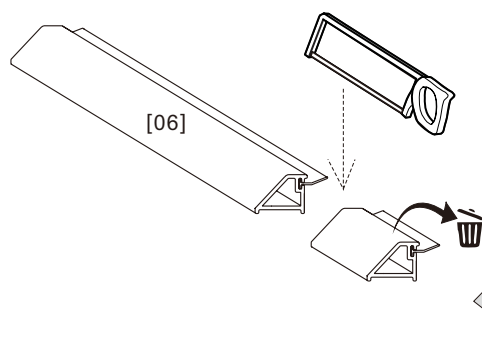



21

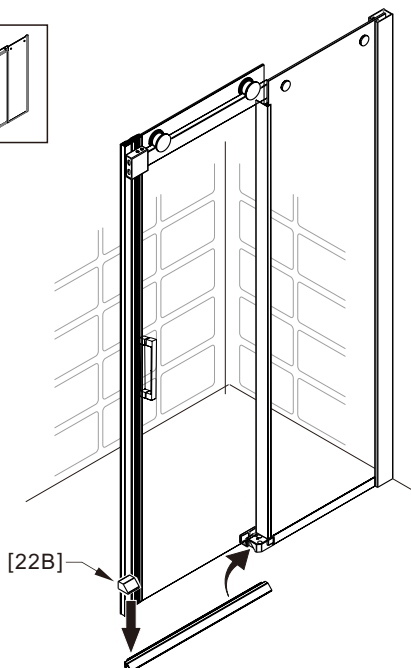
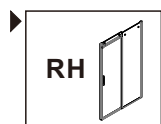
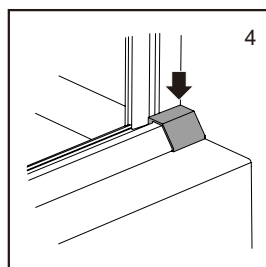
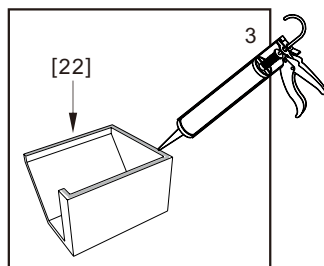
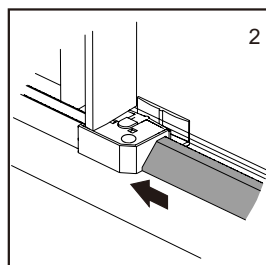
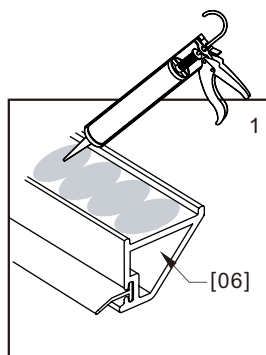
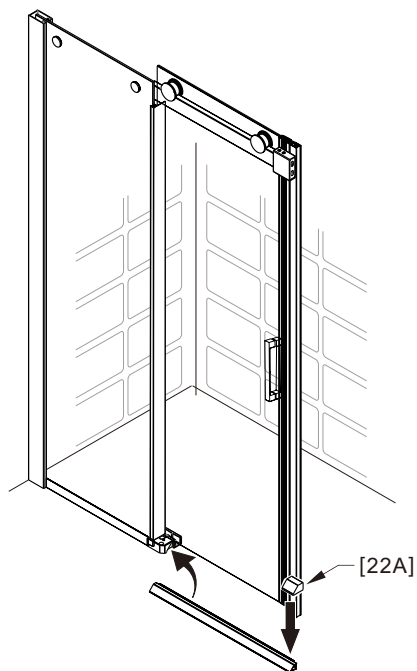
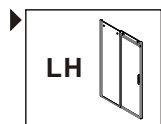

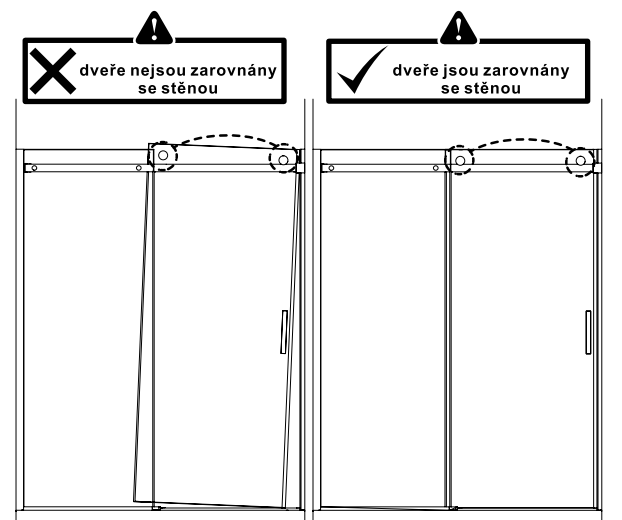

Dveřní panel  
ve své  
nejnižší  
poloze

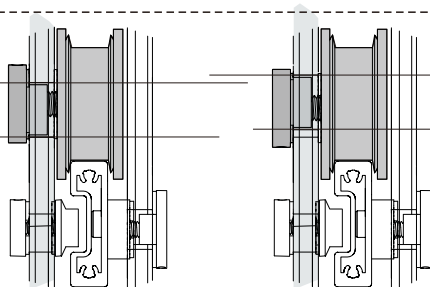
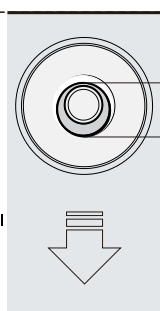

Dveřní panel  
ve své  
nejvyšší  
poloze

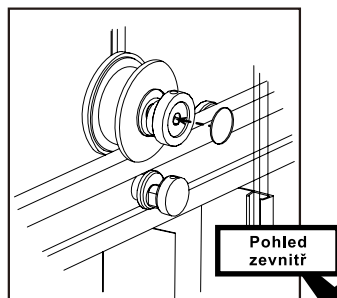
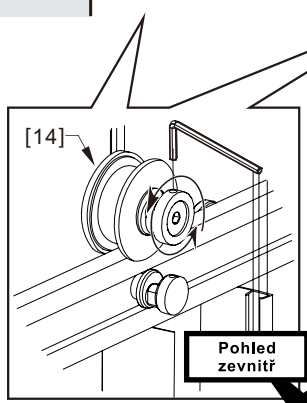
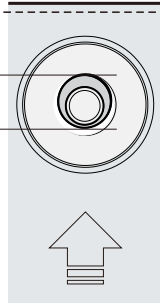

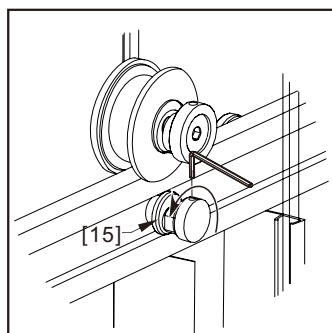
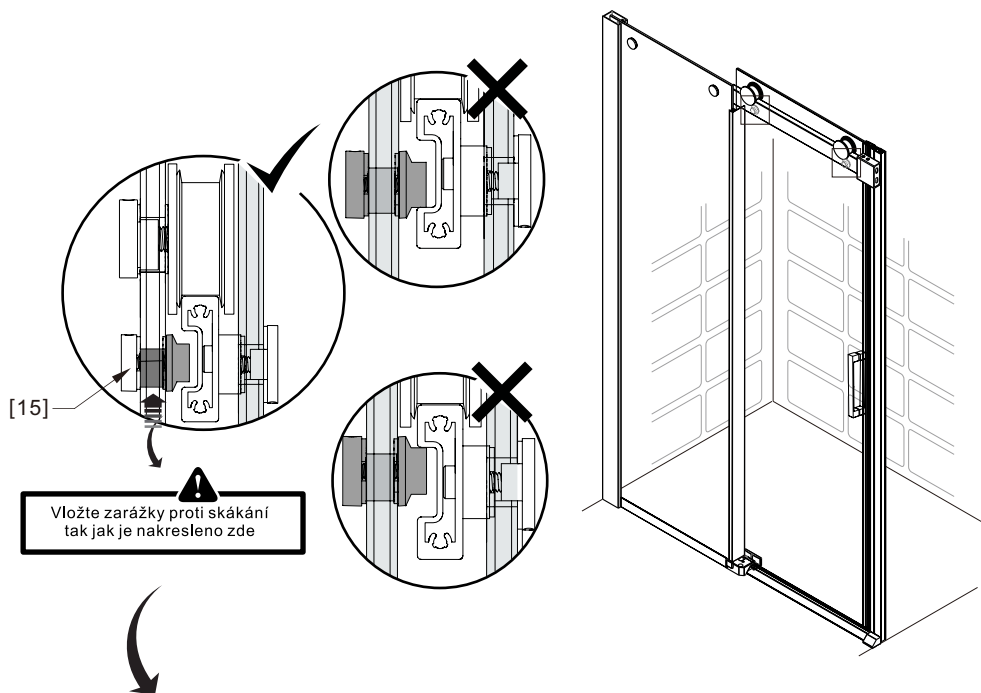

Utáhněte zárážku proti skákání

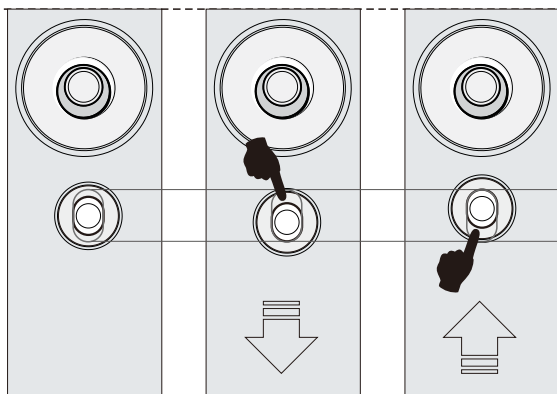

24

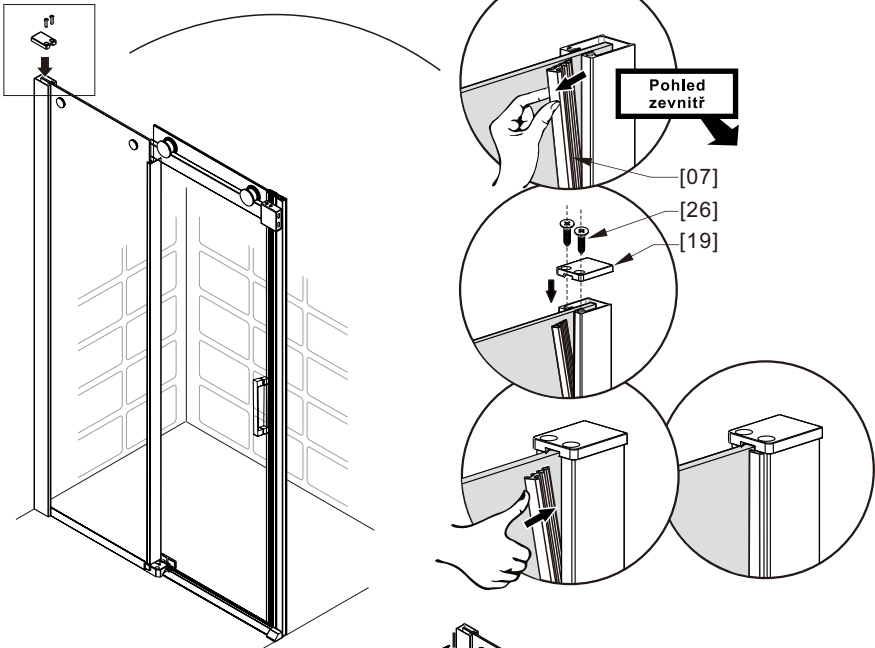

25

